



Activated Carbon
Filter



Dual Temp Zone



Soft-Close
Wooden Shelves



Adjustable LED
Light



Anti UV and Low
E Glass



Beech Wood
Shelves



Class F Energy



Flexible
Installation



Hidden Front
Hinges

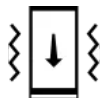

Low Vibration



Metal Handle



No Frozen



Precise Humidity
Control



Self-Evaporation
System



Wi-Fi
Connectivity



Wine Library



Wine Storage
Optimizer

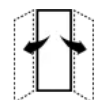

Reversible Door



Touch Electronic
Control

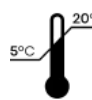

Wide
Temperature
Range

General information

Product group:	Wine store	Energy efficiency class:	F
Noise class:	C	Colour of appliance:	Black
Door material:	Stainless steel and glass	Door opening:	Right reversible
Construction type:	Freestanding	Star rating:	Wine storage
Climate classes:	Subnormal, Normal, Subtropic, Tropic		

Efficiency

Total volume:	128 L	Number of compressors:	1 compressor
Number of temperature zones:	1	Number of standard bottles:	46 pcs
Annual energy consumption (Aec):	105 kWh		

Control

Possible to control via Wi-Fi:	Yes, integrated	Type of display:	LED display
Control type:	Electronic behind the door	Temperature indicator:	Digital temperature indicator for refrigerator
Opened door indicator:	Door Alarm	Wine cooler illumination:	With function

Features

Door lock:	No	Sound and visual signal for high temperature in refrigerator:	No
------------	-----------	---	-----------

Technical data

Cooling compartment defrost mode:	Automatic	Type of refrigerant:	R600A
Laying down the appliance:	Permitted	Hidden condenser:	No
Number of independent cooling systems:	2	Width of the product:	595 mm
Height of the product:	819 mm	Depth of the product:	575 mm
Gross weight:	48 kg	Net weight:	45 kg
Width of the packed product:	640 mm	Height of the packed product:	938 mm
Depth of the packed product:	631 mm	Voltage:	220-240 V
Frequency:	50 Hz	Connected load:	60 W
Noise level (max):	37 dB(A)	Product code:	20013318

EAN code:

6921727080981
